

1215 and 1715 Pump head

2215 External filter

2315 Thermofilter

| Type | 230 V / 50 Hz Europe | 120 V / 60 Hz USA | 240 V / 50 Hz GB | 240 V / 50 Hz AUS | 220 V / 60 Hz |
|-------------|-------------------------|----------------------|---------------------|----------------------|---------------|
| 1215 | 1215019 | 1215099 | 1215119 | 1215129 | 1215189 |
| 1715 | 1715019 | - | - | - | - |
| 2215 | 2215010 | - | - | - | - |
| 2315 | 2215020 | 2215370 | 2215520 | 2215550 | 2215620 |

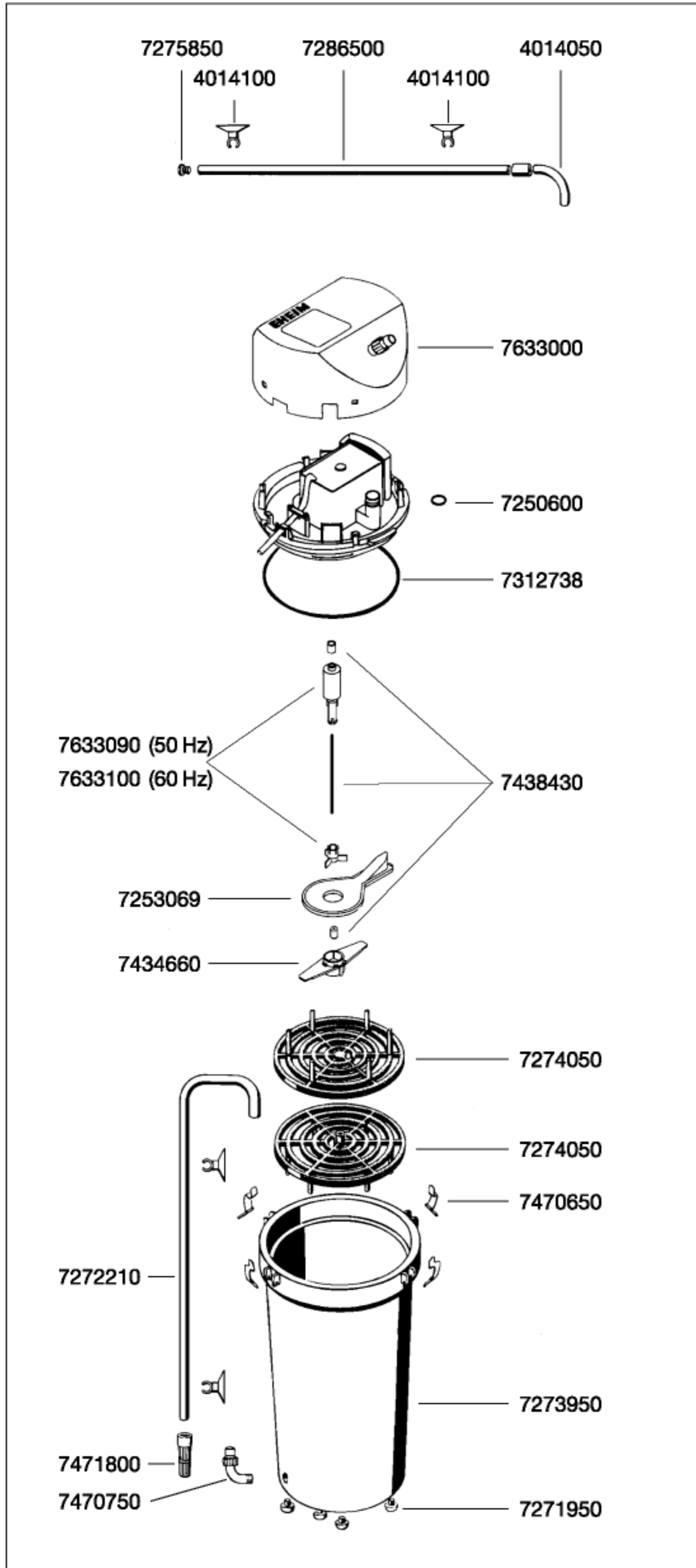

| Order no. | Spare part |
|--------------------|---|
| 1215 | Pump head |
| 4004940 | Hose, pressure and suction side |
| 4009570 | Set of cleaning brushes (not shown) |
| 4014050 | Elbow connector |
| 4014100 | Suction cup with clip ø 13 mm (2 pieces) |
| 7250600 | Sealing ring (2 pieces) |
| 7253069 | Pump cover |
| 7271950 | Rubber feet set (5 pieces) |
| 7272210 | Intake pipe |
| 7273950 | Canister |
| 7274050 | Lattice screen |
| 7275850 | Pipe plug (2 pieces) |
| 7286500 | Outlet jet pipe |
| 7312738 | Sealing ring |
| 7400008 | Filter bag (not shown) |
| 7434660 | Securing piece with bushing |
| 7438430 | Shaft with bushings |
| 7470650 | Spring clip (4 pieces) |
| 7470750 | Threaded connector |
| 7471800 | Inlet strainer |
| 7476500 | Accessories bag |
| 7633000 | Cover |
| 7633090 | Impeller 50 Hz – from series 88011 |
| 7633100 | Impeller 60 Hz – from series 88011 |
| 1715 / 2315 | (not shown) |
| 1715 | Pump head with heater only for freshwater |
| 7254760 | Fastening screw for lattice screen M 5 x 40 (2 pieces) |
| 7255860 | Lattice screen |
| 7634350 | Regulating knob |
| 7634500 | Cover |